

# Unit Plan

FLAT B | 2B 1T  
Tower I & J

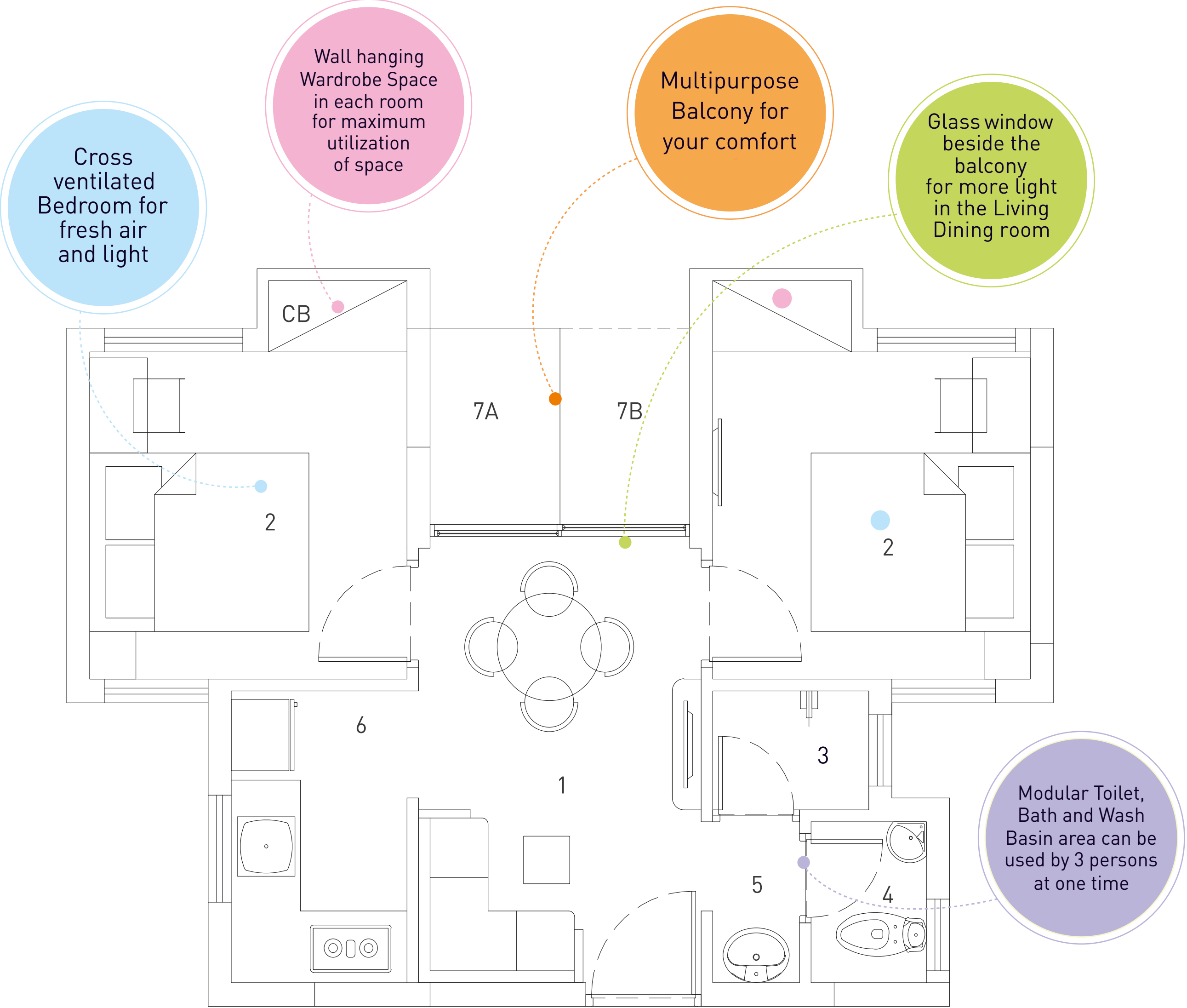

Carpet area	Carpet + Balcony area	Built up area	Standard built up area
369	389	446	620

① Living/Dining	8'0"x 12'0"
② Bedroom	9'0"x 11'0" (9'0"x 9'0"without CB)
③ Bathroom	4'5"x 3'3"
④ WC	3'3"x 4'5"

⑤ Basin	2'6"x 4'5"
⑥ Kitchen	5'0"x 8'0"
⑦A Balcony	3'8"x 5'5"
⑦B Balcony	3'8"x 5'5"

# Unit Plan

FLAT B | 2B 1T  
Tower I & J



Carpet area	Carpet + Balcony area	Built up area	Standard built up area
369	389	446	620

① Living/Dining	8'0"x 12'0"
② Bedroom	9'0"x 11'0" (9'0"x 9'0"without CB)
③ Bathroom	4'5"x 3'3"
④ WC	3'3"x 4'5"

⑤ Basin	2'6"x 4'5"
⑥ Kitchen	5'0"x 8'0"
⑦A Balcony	3'8"x 5'5"
⑦B Balcony	3'8"x 5'5"