

FLAT S | Studio  
Tower K

Unit Plan

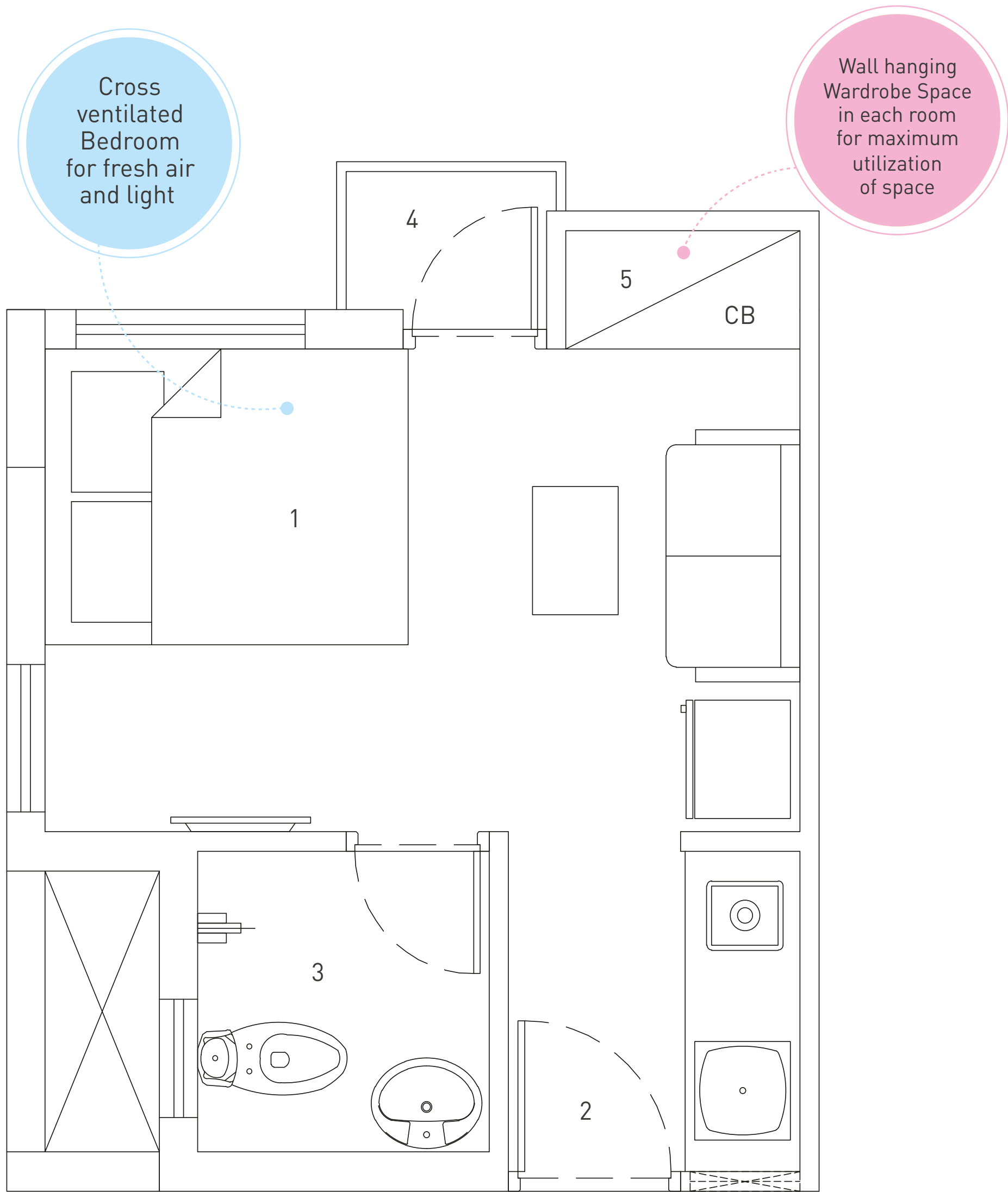

Carpet area	Built up area	Standard built up area
169	205	275

① Studio	13'0"x 8'0"
② Foyer	5'0"x 5'4"
③ Toilet	5'0"x 5'0"

④ Planter	3'11"x 2'6"
⑤ Cabinet area	3'11"x 2'0"

FLAT S | Studio  
Tower K

Unit Plan



Carpet area	Built up area	Standard built up area
169	205	275

① Studio	13'0"x 8'0"
② Foyer	5'0"x 5'4"
③ Toilet	5'0"x 5'0"

④ Planter	3'11"x 2'6"
⑤ Cabinet area	3'11"x 2'0"